

---

PARK HYATT BUSAN™

---

The Luxury Address in Busan

---

## Park Hyatt Busan

The Park Hyatt brand is a worldwide hotel brand in the top category owned by Hyatt Group. It is brand with the concept of "Contemporary Luxury," the best location and the best facilities and services.



- Open: Feb 18, 2013
- Size: B6 – 34F (Whole building is operated as hotel facility)
- Stars: 5 Stars
- Number of Room: 269 Rooms (Standard 200 + Suite 69)
- F&B Restaurants: Dining room(32F), Living room(31F), Living room Bar (31F), Lounge(30F), Patisserie(1F)
- Number of Car park: 346
- Address: 51, Marine City 1-ro, Haeundae-gu, Busan, 48120, South Korea

## Location

Park Hyatt Busan is a landmark of Busan with a panoramic view of Haeundae and Gwangandaegyo Bridge and is a luxury hotel located in Haeundae Marine City. Park Hyatt Busan, completed by world-renowned architect Daniel Libeskind and Japanese interior company Super Potato, presents a new luxury hotel paradigm in the beautiful international city of Busan.



### Distance to Locations (By car)

- BEXCO 2 km / 8 min
  - Shinsegae Department store 2 km / 10 min
  - Nurimaru APEC house 1.2 km / 5 min
  - Haeundae Beach 1.2 km / 5 min
  - Busan Train Station 13 km / 30 min
  - Gimhae Airport 30 km / 50 min
- Subway station & bus stop is close by
  - Airport Limousine Bus stop - "Park Hyatt Busan"
  - Yachting center : 5 minutes of walking distance for activities

## Venue Information (Drawing room)



### Drawing room 1

- Location: 33F
- Capacity: 36
- View: Gwangandaegyo Bridge View

### Drawing room 2

- Location : 33F
- Capacity : 20
- View : Gwangandaegyo Bridge View & Yacht Center

### Drawing room 3

- Location : 33F
- Capacity : 24
- View : Yacht Center

### Drawing room 4

- Location : 33F
- Capacity : 14
- View : Yacht Center

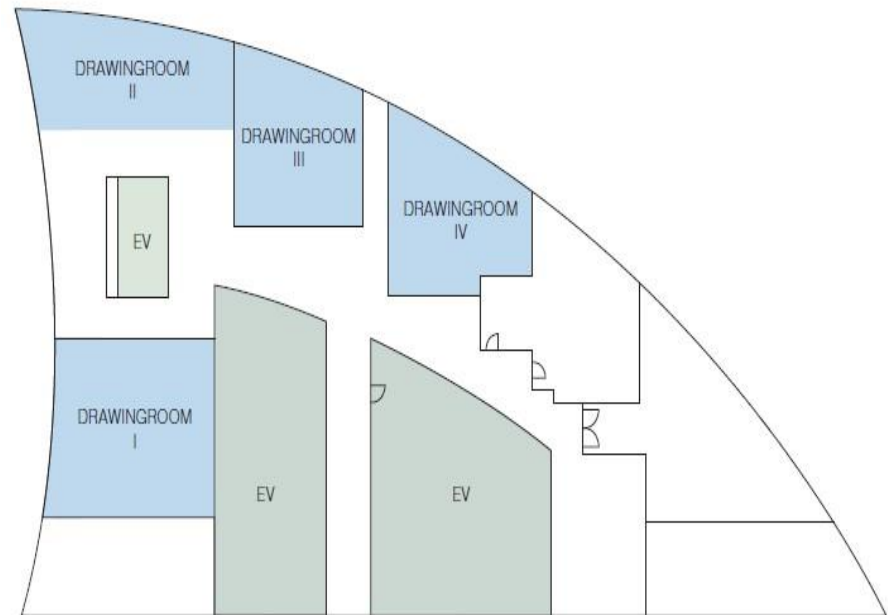

## Venue Information (Salon)

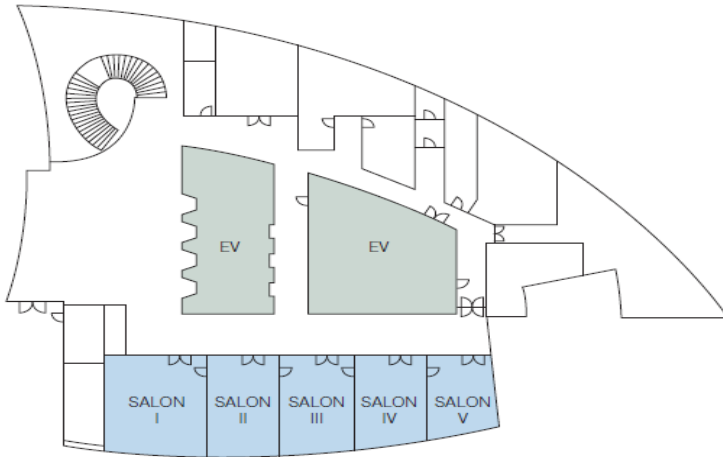

### Salon (1-5)

- Location: 1F
- Capacity: 60 Pax
- Remark:
  - High ceiling and study-style interior
  - Up to five partitions can be classified depending on event type
  - Easy accessibility for attendees
  - Built-in LED Screen



## Venue Information (Ballroom)

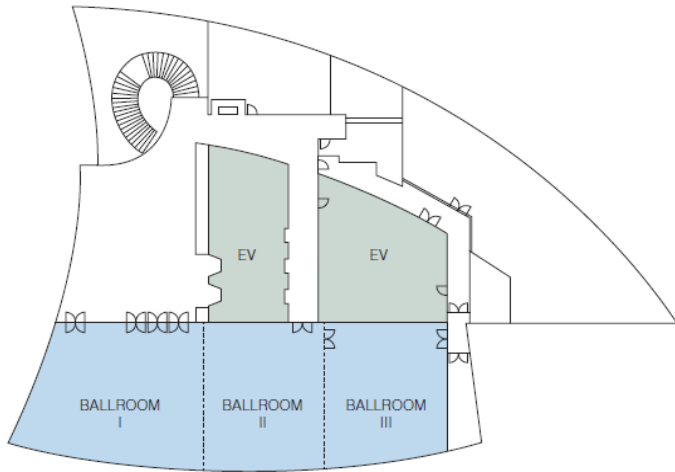

## Ballroom (1-3)

- Location: 2F
- Capacity: 200 Pax
- Remarks:
  - View of Gwangandaegyo Bridge in the high ceiling and banquet hall
  - Up to three partitions can be classified depending on event type
  - Easy accessibility for attendees
  - Use of 2nd floor whole floor
  - VIP waiting space can be prepared separately
  - Built-in LED Screen



---

## Room Information

### Number of Rooms per Room type (Total 269 Rooms)

- Park King: 69 rooms
- Park Deluxe King: 37 rooms
- Park Deluxe Family Twin: 32 rooms
- Ocean View King: 27 rooms
- Ocean View Twin: 6 rooms
- Ocean View High Floor King: 23 rooms
- Ocean View High Floor Twin: 6 rooms
- Family Suite: 23 rooms
- Family Ocean Suite: 11 rooms
- Marina Ocean Corner Suite: 23 rooms
- Premium Family Ocean Suite: 11 rooms
- Diplomat Suite: 2 rooms
- Presidential Suite: 1 room



# Diplomat Suite

- 2 Rooms in total / Located on 27F, 28F
- 154 Square metre



# Presidential Suite

- Highest level of room type. Location on 29F
- 198 Square metre



## Facilities

The indoor swimming pool and fitness center are free for all guests.

\* There are extra charge for sauna and spa massage.



---

**Restaurant** Website: <https://restaurants.parkhyattbusan.com/en/>



---

## Inquiry

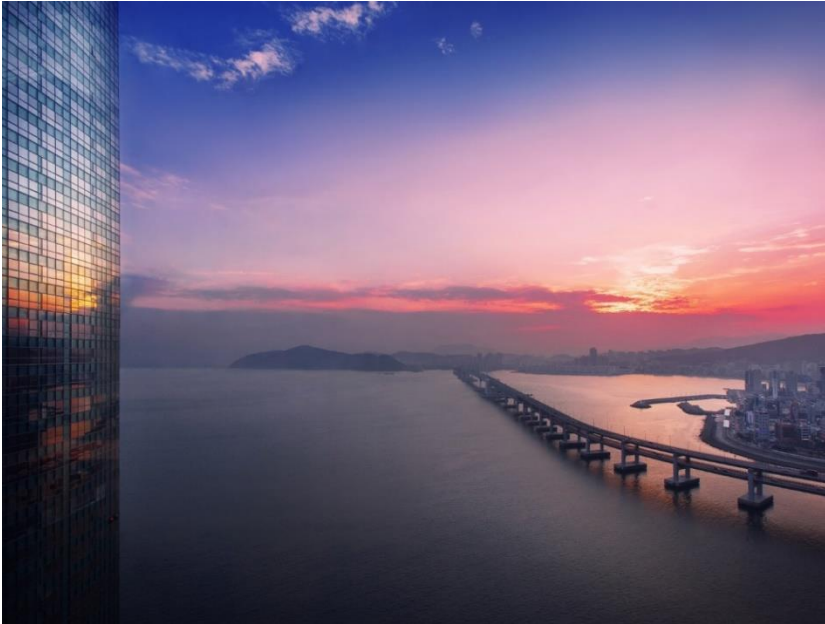

- Name: Junyong Kim
- Title: Sales Manager
- Contact: +82 51-990-1358 / +82 10-2771-4210
- E-mail: [Junyong.kim@hyatt.com](mailto:Junyong.kim@hyatt.com)